



## 75 Burden Drive, Bishopdown, Salisbury, Wiltshire, SP1 3QG

\*\*\* VIEWINGS ON HOLD DUE TO HIGH DEMAND \*\*\*

- 3 BEDROOM
- 1 BATHROOM
- SEMI-DETACHED
- MODERN BUILD
- OFF STREET PARKING
- NEWLY TURFED LAWN
- GAS CENTRAL HEATING
- EPC BAND B

£1,250 PCM

### Ground Floor

Approx. 41.4 sq. metres (445.5 sq. feet)

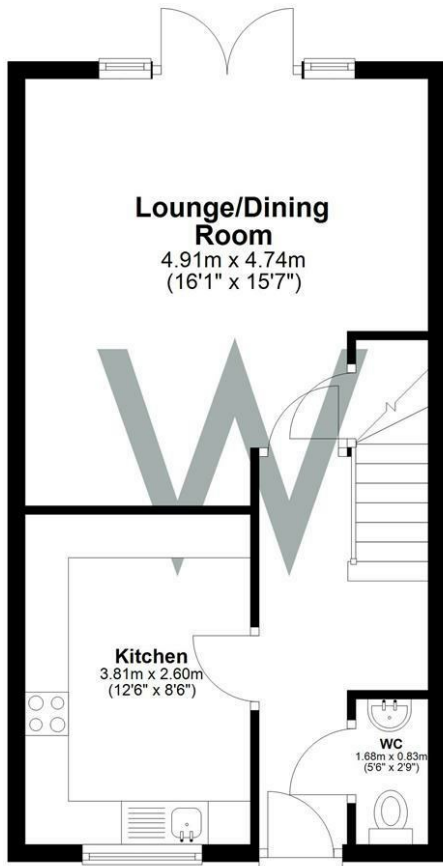

### First Floor

Approx. 37.3 sq. metres (401.8 sq. feet)

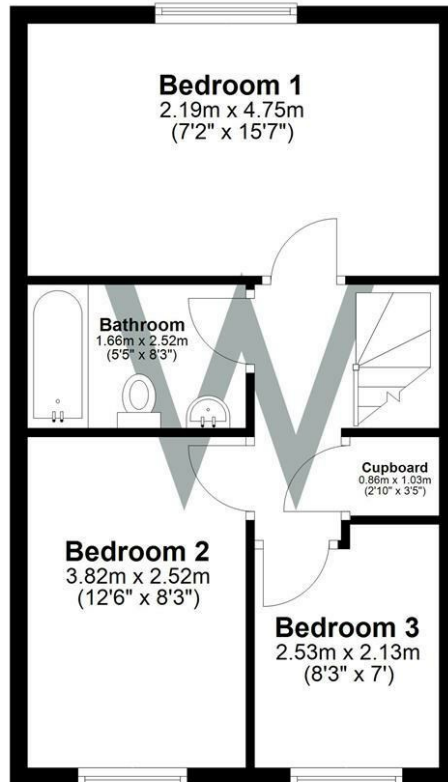

Total area: approx. 78.7 sq. metres (847.3 sq. feet)

### WHITES

Castle Chambers, 47 Castle Street, Salisbury,  
Wiltshire, SP1 3SP  
Tel: 01722 336422/Option 2  
www.hwwhite.co.uk  
email: lettings-management@hwwhites.co.uk

Energy Efficiency Rating		Current	Potential
Very energy efficient - lower running costs			
(92 plus) <b>A</b>			<b>96</b>
(81-91) <b>B</b>		<b>84</b>	
(69-80) <b>C</b>			
(55-68) <b>D</b>			
(39-54) <b>E</b>			
(21-38) <b>F</b>			
(1-20) <b>G</b>			
Not energy efficient - higher running costs			
<b>England &amp; Wales</b>		EU Directive 2002/91/EC	

Environmental Impact (CO <sub>2</sub> ) Rating		Current	Potential
Very environmentally friendly - lower CO <sub>2</sub> emissions			
(92 plus) <b>A</b>			
(81-91) <b>B</b>			
(69-80) <b>C</b>			
(55-68) <b>D</b>			
(39-54) <b>E</b>			
(21-38) <b>F</b>			
(1-20) <b>G</b>			
Not environmentally friendly - higher CO <sub>2</sub> emissions			
<b>England &amp; Wales</b>		EU Directive 2002/91/EC	